

## WIFI Installation Guide

1

Remove the metal plate as shown in below Figure.

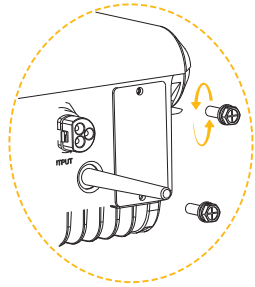

2

Take out WIFI module from fitting bag, and connect the exposed WIFI interface to DB9 terminal, and check that the connection is well with an appropriate force.

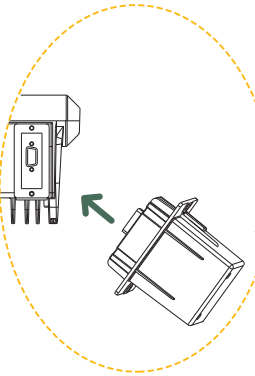

3

Open APP and choose "Bluetooth", click BLExxxx to login. Then click the function list and choose Setting.

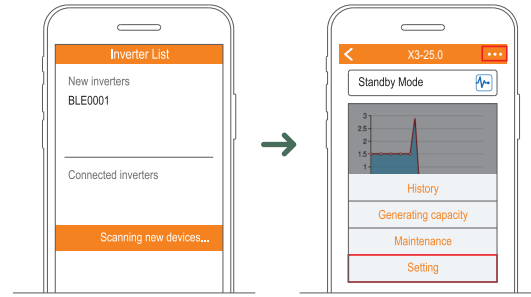

4

Click switch user, enter password "admin" to login with administrator account.

Click WIFI Setting to enter WIFI router name & password.

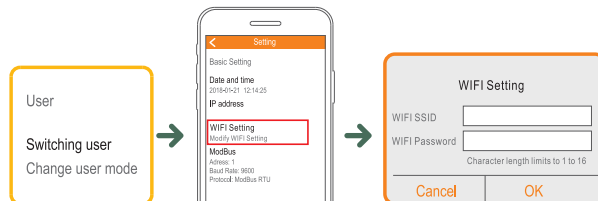

5

WIFI module need 10 to 15 seconds to connect with WIFI router. After WIFI Setting finish, APP will show the result: "WIFI Connected" means connection successful. "WIFI Setting Failed" means connection failed. If WIFI connection failed, repeat step 4 & 5.



7

Bind the cloud account using APP referring to the appendix.

6

Register a cloud account refer to appendix (Referring to appendix).

## GPRS Installation Guide

1

Remove the locking screws on the bottom of the PV inverter, and take down the metal plate.

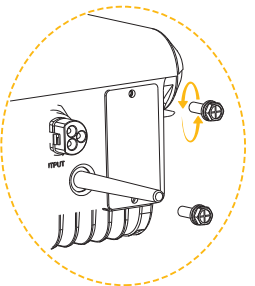

2

Connect the GPRS module to the DB9 terminal of the PV inverter, and ensure well connecting and no automatic slide.

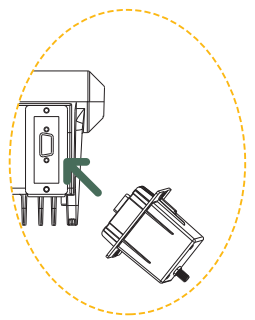

4

Connect GPRS antenna correctly (before connecting, double check the antenna is of GPRS).

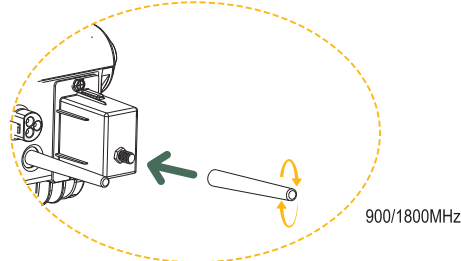

3

Tighten the screw locking GPRS module with appreciate force, otherwise the connecting will loosen or damage on the GPRS module will occur.

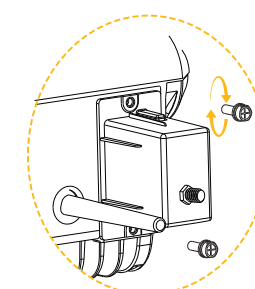

5

Register a cloud account referring to the appendix.

6

Bind the cloud account using APP referring to the appendix; the cloud account provides access to the running data of the PV inverter.

## Appendix

### APP Download

1

Scan APP download QR code in Quick Installation Manual to download the APP.

## Register a Cloud Account

When using WIFI or GPRS modules, register a cloud account for equipment's networking monitoring, and bind the account with the PV inverter. The PV inverter's operational data will be uploaded to the cloud account after it is grid-tied. You can skip this step when you have registered a cloud account before.

1

You can access the user registration page by clicking Register icon in the APP, or inputting cloud web domain name in the browser (Find the web domain name in Quick Installation Manual) and click Register icon. Then you will be prompted for some basic registration information from the system till the end.



2

You will receive the registration mail. Open the mail and click activation link to activate your account and finish registration process.

2

Enter power station information, then press “Add” to scan inverter serial number barcode.

New power station

Please enter a name

Address

Please enter an address

Capacity

0

kw

E-Total Base

0

kwh

Device List

Please choose device

Add

Save

SN barcode reference pattern:

SN

1701-37950041D

PV1-03KA230-AAAA

Binding Cloud Account with APP

1

Login APP with your account. Click List icon and press “+”.



3

Press Save to finish the binding process.

New power station

Power Station

Address

New York

Capacity

60

kw

E-Total Base

0

kwh

Device List

1800-12345678D

Please choose device

Add

Save