

LOGISTICS MANUAL EMEA

Jan. 2022

Contents

Introduction	4
Packaging & Labeling	6 - 7
Module handling/storage instructions except (Bi)HiKu7 modules	9 - 14
Module handling/storage instructions for (Bi)HiKu7 modules	16 - 42
Transport Service	44 - 46
Customs clearance	48 - 50
Product Master data	52 - 64

INTRODUCTION

Introduction

Our goal is to offer the best Logistics service to our customers in order to fulfill the needs and demands
- working together we will **MAKE THE DIFFERENCE!**

This Logistics Manual* is designed to explain our logistical conditions such as transport modes, packaging, the corresponding handling of our modules we provide among other logistics value added services.

* The information in our Logistics Manual EMEA is for your internal use only and contains confidential and proprietary information and business secrets of Canadian Solar ("Confidential Information").

You are obligated not to disclose the content of this Logistics Manual or make this Confidential Information available to any Third party.

You may not copy, modify or publish the Logistics Manual or make its content available externally (e.g. your website or in Internet).

PACKAGING & LABELING

Module Packaging – Labeling

Transparent and scannable!

On each pallet the data sheet is attached where you will find all relevant information.

Material code

Serial No.

Pallet ID

Pallet Group ID

CanadianSolar		Material Code	Barcode	Cell Type	Cell Size	Cell Color	Pattern	Bus Bar	Cable	Frame	Backsheet
CSXX-XXXY		10000786	10000786	Poly	156*156	Blue	Bright	5	1000/500 mm	Silvery-F16	White
No.	Barcode	Pm(W)	Im(A)	No.	Barcode	Pm(W)	Im(A)	No.	Barcode	Pm(W)	Im(A)
1	[Barcode]	1234	789	11	[Barcode]	0	0	21	[Barcode]	0	0
2	[Barcode]	0	0	12	[Barcode]	0	0	22	[Barcode]	0	0
3	[Barcode]	0	0	13	[Barcode]	0	0	23	[Barcode]	0	0
4	[Barcode]	0	0	14	[Barcode]	0	0	24	[Barcode]	0	0
5	[Barcode]	0	0	15	[Barcode]	0	0	25	[Barcode]	0	0
6	[Barcode]	0	0	16	[Barcode]	0	0	26	[Barcode]	0	0
7	[Barcode]	0	0	17	[Barcode]	0	0	27	[Barcode]	0	0
8	[Barcode]	0	0	18	[Barcode]	0	0	28	[Barcode]	0	0
9	[Barcode]	0	0	19	[Barcode]	0	0	29	[Barcode]	0	0
10	[Barcode]	0	0	20	[Barcode]	0	0	30	[Barcode]	0	0
Pallet Group ID		Module Quantity	N.W.	G.W.	Volume		Pallet No.				
[Barcode]		XX PCS/Pallet	XXX Kg/Pallet	XXX Kg/Pallet	XXX*XXX*XXX cm³		[Barcode]				
18120300401		XXX PCS/CTR	XXX Kg/CTR	XXX Kg/CTR	XXX m³		180341201200				
Unpacking Instruction		CE	www.canadiansolar.com support@canadiansolar.com		Max System Voltage		IEC1000V&UL1000V				
[QR Code]		Assembled in China with Chinese cells									

Module Packaging – Labeling

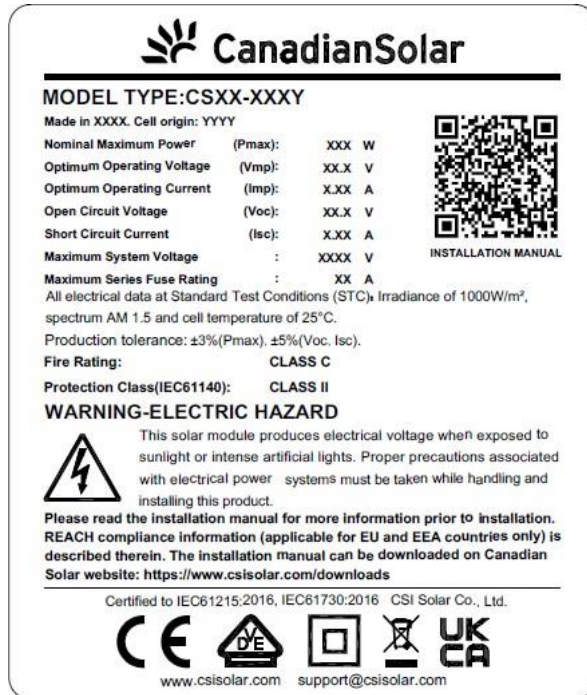

CanadianSolar

MODEL TYPE:CSXX-XXXY

Made in XXXX. Cell origin: YYYY

Nominal Maximum Power	(Pmax):	XXX W
Optimum Operating Voltage	(Vmp):	XX.X V
Optimum Operating Current	(Imp):	X.XX A
Open Circuit Voltage	(Voc):	XX.X V
Short Circuit Current	(Isc):	X.XX A
Maximum System Voltage	:	XXXX V
Maximum Series Fuse Rating	:	XX A





QR code and **INSTALLATION MANUAL** link

All electrical data at Standard Test Conditions (STC): Irradiance of 1000W/m², spectrum AM 1.5 and cell temperature of 25°C.
Production tolerance: ±3%(Pmax), ±5%(Voc, Isc).
Fire Rating: CLASS C
Protection Class(IEC61140): CLASS II
WARNING-ELECTRIC HAZARD

 This solar module produces electrical voltage when exposed to sunlight or intense artificial lights. Proper precautions associated with electrical power systems must be taken while handling and installing this product.

Please read the installation manual for more information prior to installation. REACH compliance information (applicable for EU and EEA countries only) is described therein. The installation manual can be downloaded on Canadian Solar website: <https://www.csisolar.com/downloads>

Certified to IEC61215:2016, IEC61730:2016 CSI Solar Co., Ltd.

www.csisolar.com support@csisolar.com



Our modules fulfill the VDE standards

Every module is labeled with a barcode (EAN128 standard) on the exterior of the frame

**MODULE HANDLING & STORAGE
INSTRUCTIONS FOR MODULES
EXCEPT (BI)HIKU7 MODULES**

Handling requirements - Pallets

Our products are packed according to our Canadian Solar standards

- Our pallets are composed of plywood and cardboard
- According to the ISPM (International Standards for Phytosanitary Measure) rules of international shipping , plywood and cardboard do not require a fumigation certificate
- Pallets are wrapped in plastic and are double stacked
- Four-way-pallets and can be stored and handled from every side and in every direction
- Low-profile-pallets (8 cm height between groundfloor and pallet) need to be handled with special forks (~7.5 cm height)



Handling requirements – Unloading container

Canadian Solar offers 20ft, 40ft and 40ft High Cube general purpose containers

- Unloading the double pallets using a loading dock
- Loading dock must be flush and on the same level as the truck or container
- Our pallets are customized and bigger than a standard European pallet to provide proper transport for the modules, but they can be handled with a forklift which is used for EPAL
- In order to carry the pallets from the short edge the usage of extended forks are necessary



Handling requirements – Unpacking instructions

Following instructions valid for all Canadian Solar modules except (Bi)HiKu7:

- The modules are packed vertically on the **long side** in the box
- Pallets should be placed on a flat area before unpacking
- Always two workers have to carry modules out of the box
- Always use both hands when handling the modules



Unpacking Instructions

1/2

- Disconnect / Remove the three packaging belts
- Open/Remove the upper cover of the box
- Disconnect/Remove the vertical and upper horizontal packaging belts
- Tear off the hook and remove it from the upper front cover



Unpacking Instructions

2/2

- Bend the front cover along the middle cutting line



- Two workers peel off cardboard tapes at both ends of one module at a time



- The tapes need to be rolled up as shown on the picture
- Two workers take the module out off the box
- Repeat the peeling
- Remove modules one at a time



Storage

BULK STORAGE

Pallets should be stored over hard and even ground

- Maximum two pallets are to be stacked on top of each other. **EXCEPTION** pallets of HiKu7 and BiHiKu7 are not stackable!
- It is forbidden to stand on top of the pallets or lose modules



HIGH RACK STORAGE

Our modules can also be stored on racks

- Pallet rack is a material handling storage aid system designed to store materials on pallets
- Maximum two pallets are to be stacked on top of each other in racks! **EXCEPTION** pallets of HiKu7 and BiHiKu7 are not stackable!



Handling requirements – Unloading HiKu 7 Tautliner

- Unloading (Bi)HiKu 7 from side of the tautliner, handling space (height) is limited by 8,5 cm
-> Pallet total height 2500cm – 2585cm height tautliner -> ~8,5cm free handling space
- Unloading (Bi)HiKu 7 from side of Tautliner: Free space between bottom of the Pallet (Bi)HiKu 7 of ~ 6,5cm

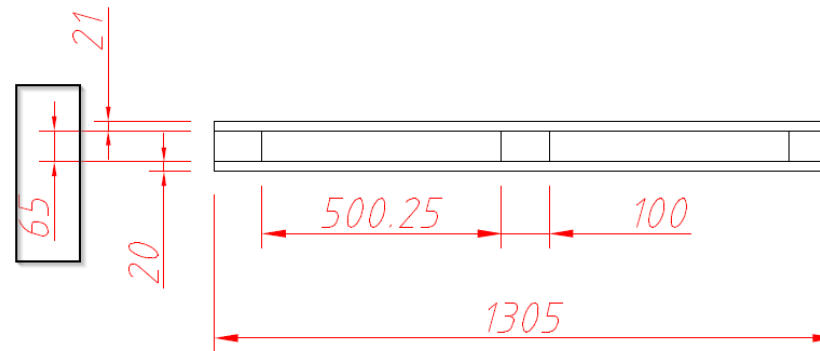

- Unloading (Bi)HiKu 7 from back of the truck (ramp): Free space between bottom of the Pallet (Bi)HiKu 7 of ~ 8,5cm

Handling requirements – Unloading HiKu 6 Tautliner

Unloading (Bi)HiKu 6 from back of the tautliner (using ramp): Free space between bottom of the Pallet (Bi)HiKu 6 of $\sim 8,5\text{cm}$

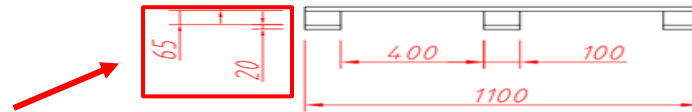

Unloading (Bi)HiKu 6 from side of the tautliner, handling space (height) is limited by 8,5 cm
-> Pallet total height 2500cm – 2585cm height tautliner -> $\sim 8,5\text{cm}$ free handling space



MODULE STORAGE AND HANDLING INSTRUCTIONS FOR (BI)HIKU7 MODULES

Purpose of the document

- Canadian Solar had added new Ultra high-power big size modules (HiKu7/BiHiKu7) which needs special attention for transportation, handling, and storage requirements which is typically different than the other standard modules because of special packing, large size and weight.
- This document includes instructions for module unloading, transfer process, handling and storage requirements.
- For more details, please refer to CSI standard installation manual or contact with your CSI representative.

Applicability: Canadian Solar (CSI) HiKu7 and BiHiKu7 modules - CS7L-MS, CS7N-MS, CS7L-MB-AG and CS7N-MB-AG.

Product Introduction

MODULE					PALLET			CARTON			
Module Type	Frame Type	Glass Thickness (mm)	Dimensions (mm)	Weight (kg)	Dimensions Empty Pallet (mm)	Dimension Loaded Pallet (mm)	Weight Loaded Pallet (kg)	Dimensions Empty Carton (mm)	Modules /Carton	Cartons/ Pallet	Modules /Pallet
CS7N-MS	F52	3.2	2384 x 1303 x 35	34.4	1305 x 1100 x 105	1340 x 1135 x 2500	1114	1305 x 1090 x 2105	31	1	31
CS7N-MB-AG	F43	2	2384 x 1303 x 35	37.9	1305 x 1100 x 105	1340 x 1135 x 2500	1223	1305 x 1090 x 2105	31	1	31
CS7L-MS	F52	3.2	2172 x 1303 x 35	31.4	1305 x 1100 x 105	1340 x 1135 x 2282	1021	1305 x 1090 x 1893	31	1	31
CS7L-MB-AG	F43	2	2172 x 1303 x 35	34.6	1305 x 1100 x 105	1340 x 1135 x 2282	1121	1305 x 1090 x 1893	31	1	31

Module	Pallets/ 40HQ Container	Module Qty (pcs)			Key Info for 40 HQ Trailer		
Module Type		20 Ft Container	40 Ft Container	40 HQ Container	Gross Weight (kg)	Net Weight (kg)	VOLUME (CBM)
CS7N-MS	17	/	/	527	18945	18129	64.64
CS7N-MB-AG	17	/	/	527	20789	19973	64.64
CS7L-MS	17	/	/	527	17364	16548	59.00
CS7L-MB-AG	17	/	/	527	19050	18234	59.00

Handling requirements - Pallets

Packing Design Details

- Vertical packed on the **short side** of the pallet:
31 pieces / pallet
- Interior overall design
- Integrated wooden external pallet reinforcement for increased stability
- Four corner edge protection
- Anti-Tip design
- According to the ISPM (International Standards for Phytosanitary Measure) rules of international shipping , plywood and cardboard do not require a fumigation certificate



Handling requirements at the project site

1. Product arrival at the project site

customer should follow the unloading instructions described in the installation manual in addition to the recommendations mentioned in this document



The customer should confirm whether the physical appearance of the delivered modules/pallets are in good condition

Handling requirements – General requirements

2. Forklift requirements

While unloading by using the forklift, please note:

- The loading/lifting capacity of forklift > 1.5T
- It is suggested that the forklift arm length range is 1.25m ~ 1.3m.
- If the fork arm is longer, then please pay attention **not to insert** it into the front side of the next pallet/box during loading and unloading.

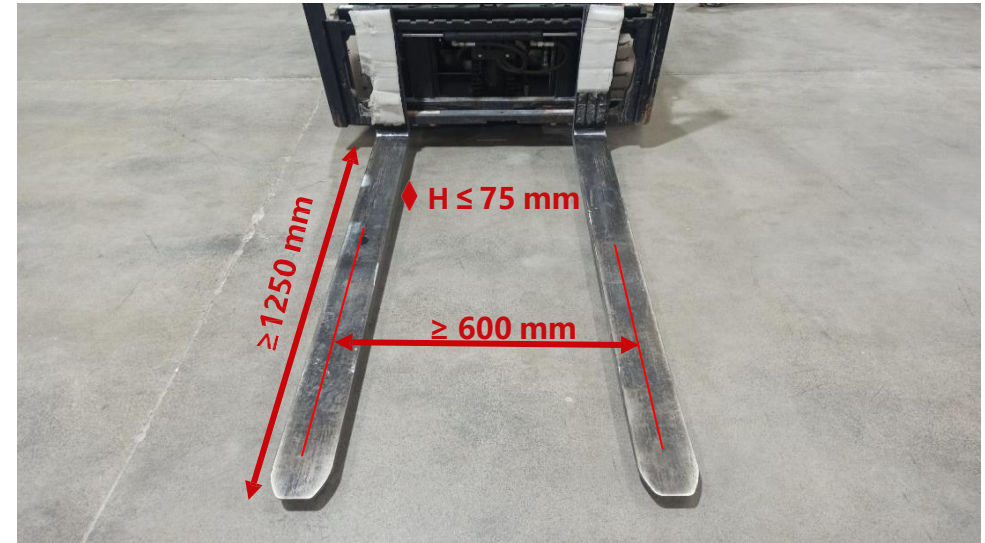

Handling requirements at the project site

3. Use forklift / crane to unload pallets

While unloading by using the forklift, please note:

- Add cushioning materials, e.g. foam cotton and other buffer materials to the forklift supporting arm in to prevent the pallets from any damage.
- During lifting operations, do not allow any sudden jerk or pallet tilting operation.
- The single hoisting of the crane is not advisable to exceed more than 1 large pallet to keep the sling flat to prevent the pallets from colliding, rotating, and squeezing in the air to avoid causing micro cracks.



Handling requirements at the project site

4. Crane lifting operations while unloading from truck

Please note:

- A skilled operator is required to operate.
- The length of the lifting wire rope should be adjusted according to the number of pallets (not more than two) and add horizontal support rod in between two ropes (recommended).
- Try to keep minimum distance between pallet and the crane as much as you can to avoid twisting of the ropes.
- Total length of a single rope should be more than or equal to 9m when lifting with a single Pallet; When lifting double pallets, the total length of a single rope should be at least of 12m.

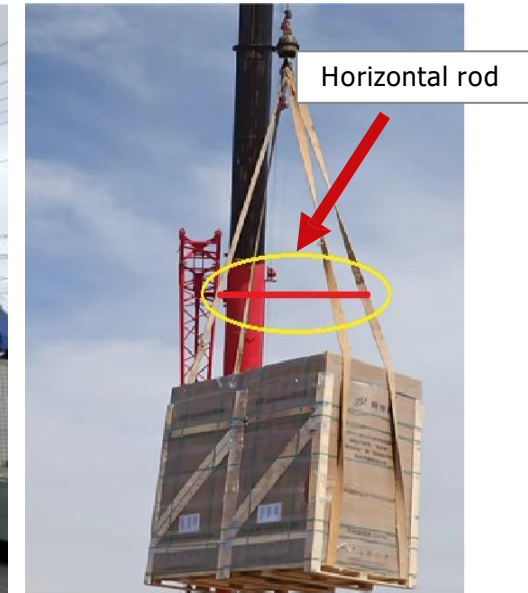

Handling requirements at the project site

5. Pallets handling and positioning

Please note:

- When pallets are being lifted by a forklift or crane, please move gently to prevent the pallet from shaking, jerking or hitting on the ground, which may cause micro-cracks. Forklift speed should **not more than 10km/h**.
- When the pallet is in the air (before put on the ground), there should be manually stabilized to prevent it's violently hitting the ground, which may cause micro-cracks to the modules.



Handling requirements at the project site

6. Unloading container

Please note:

- Container bottom level and the loading/ unloading platform level must be at the same level, and the inclination angle must be $\leq 3^\circ$.
- The forklift needs to travel slowly when it comes out of the container pathway while having pallets loaded on the forklift arms.



Unloading requirements



Handling requirements – Unloading (Bi)HiKu 7 Tautliner

- Unloading (Bi)HiKu 7 from side of the tautliner, handling space (height) is limited by 8,5 cm
-> Pallet total height 2500cm – 2585cm height tautliner -> ~8,5cm free handling space
- Unloading (Bi)HiKu 7 from side of Tautliner: Free space between bottom of the Pallet (Bi)HiKu 7 of ~ 6,5cm

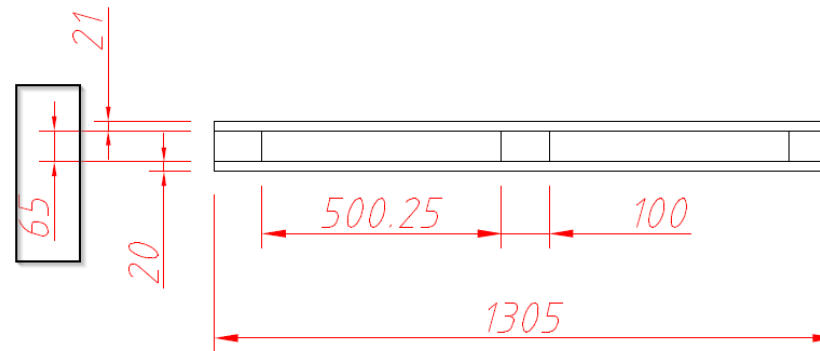

- Unloading (Bi)HiKu 7 from back of the truck (ramp): Free space between bottom of the Pallet (Bi)HiKu 7 of ~ 8,5cm

Handling requirements at the project site

7. Loading container/trailer/truck

Please note:

- Max. forklift vertical (Upside) hoisting inside the container $\leq 40\text{mm}$



Handling requirements at the project site

8. To carry two pallets on the forklift arm is strictly prohibited

Please note:

- The forklift operator needs to take extra precautions while moving the forklift while driving in a forward direction (e.g. loading truck)
- The forklift operator needs to be watchful while lifting the fork arm especially at reloading with a higher level.



Handling requirements at the project site

9. Unloading with short-supporting arms forklift not allowed

Please note:

The use of a forklift (as per pictures) with short supporting arms is not allowed because of insufficient support to the pallets.

- **Additional wooden supports** for the arm extension are **not allowed** to avoid safety concern for product as well as persons.
- **Caution:** Unload from both sides of the pallet to avoid modules breakage or generation of micro-cracks caused by impact when unloading the the pallets.

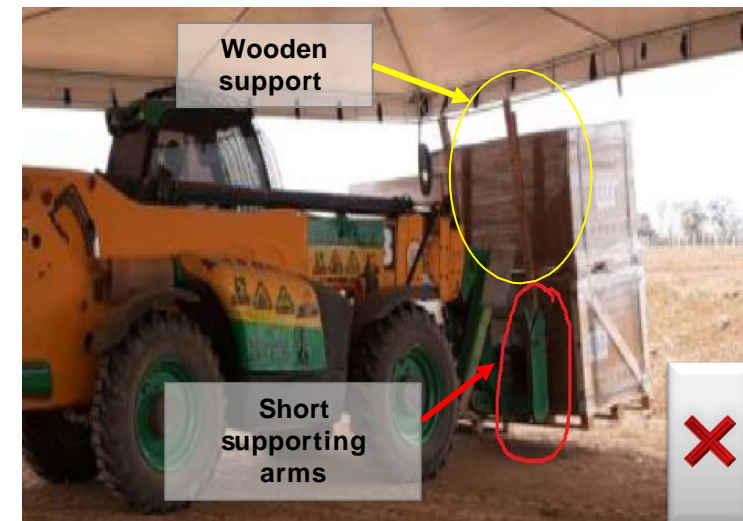
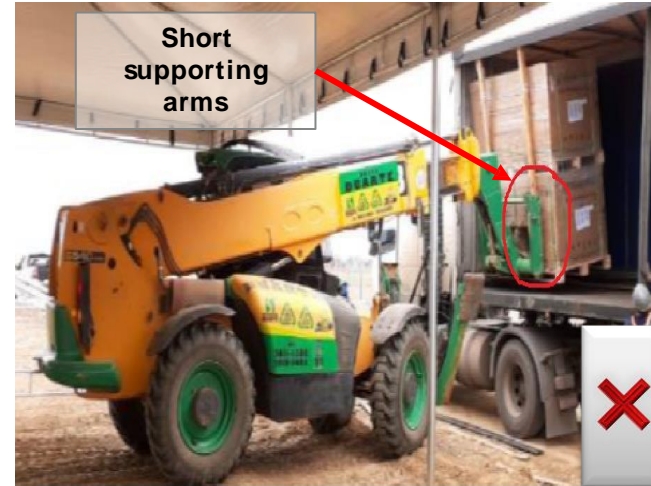

Handling requirements at the project site

10. Avoid the use of high fence vehicles

Please note:

- In case you have to use high fence vehicles, a buffer protection shall be provided on the fence of the vehicle (to avoid metal protrusions such as screws on the high fence, which may cause the modules to crash during loading / unloading / transportation).



Handling requirements at the project site

11. Transfer vehicle requirements

Please note:

- Please store the modules in a warehouse or closed premises
- Store in upright position
- Do not stack one pallet over another (only single row/pallet placement is allowed)
- Modules should be stored in a dry and ventilated environment to avoid direct sunlight and moisture



Unpacking Instructions

1/12

Following instructions valid for HiKu7 & BiHiKu7 up to 670 W:

1. Place pallets on a flat ground

CS7N & CS7L modules are packed vertically using an innovative packaging system. Please place pallets on flat ground. The inclination of the ground should not exceed 4°.



Flat ground



Inclination $> 4^\circ$



Unpacking Instructions

2/12

Unpack with anti-tipping bracket when the inclination is $0^\circ < \text{Angle} \leq 4^\circ$

Please place the pallets in the right direction (shown as below) and use an overturning protection to ensure the safety of the modules. Please check the details in the next appendix step.



Place the pallet in right direction
(The lower wooden fence leans
back is the right direction)

Support with wooden
bracket

Anti-tipping group
onsite picture

Unpacking Instructions

3/12

Appendix Step: Simple anti-tipping beams making process

Two wooden beams are needed to assemble the overturning protection. After carefully unpacking the first two pallets on a flat ground, two wooden brackets/beams will remain.

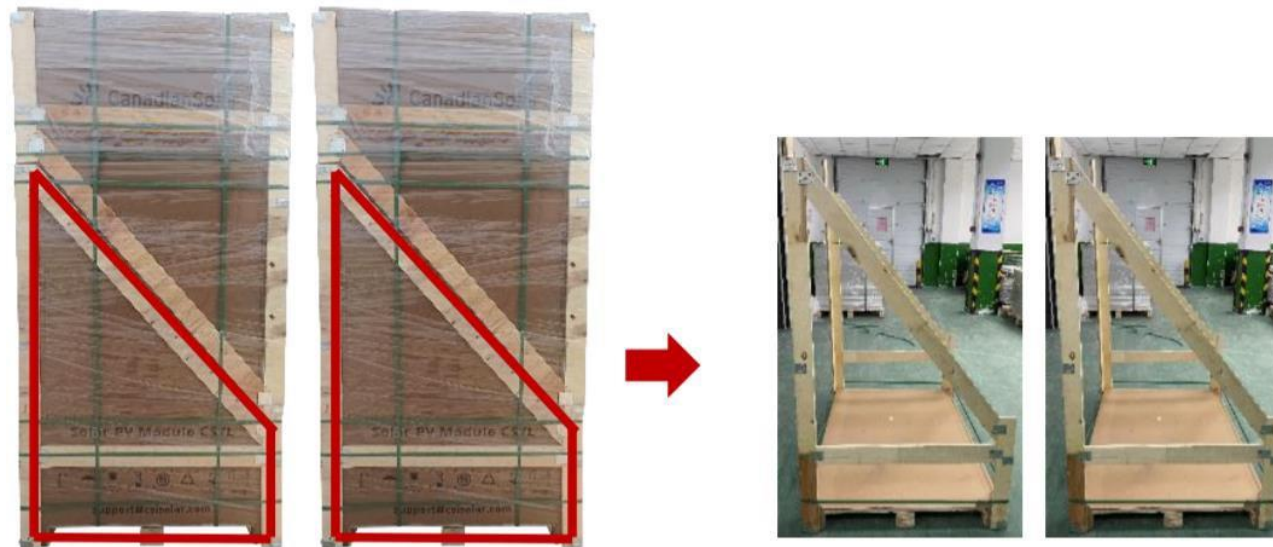

2 pallets of modules

2 wooden beams

Unpacking Instructions

4/12

Appendix Step: Simple anti-tipping beams making process

Assembly process:



2 wooden beams



Insert



Insert one bracket inserted into the other.



Simple anti-tipping bracket

Unpacking Instructions

5/12

2. Tear off the box shrink-wrap film

Tear off all the shrink-wrap film covering the box.

Attention :

- Please wear gloves to prevent hand injury.
- Please remove the shrink-wrap film with care and avoid pulling with excessive force.
- Unpacking operation shall not be carried out over wind force 6 (Strong Breeze, 10.8-13.8 m/s).



Unpacking Instructions

6/12

3. Remove outer packaging straps

Cut off the packing straps on the outside of the packing box, leaving the two bottom straps unchanged.

Attention :

- Please wear gloves to prevent hand injury.
- Please do make sure the bottom two straps remain uncut.
- Please pay attention when cutting off the straps to avoid it from springing back to avoid personal injury.



Do not remove!

Unpacking Instructions

7/12

4. Remove the upper wooden beams and box top cover

The wooden edge protection is divided into two parts: upper and lower. Please remove the upper wood edge protection, keep the lower wood edge protection, and then remove the top box cover.

Attention :

- Please wear gloves to prevent hand injury.
- Please note the wood edge protection is heavy. Refrain from letting it fall to the ground directly to avoid personal injury.
- It is recommended to remove the top cover with the help of one of the wooden brackets.



Unpacking Instructions

8/12

5. Remove the upper carton

CS7N & CS7L products packaging uses a one-piece enclosure with a broken line design. Please tear off the box along the broken line and take off the upper part of the carton.



Front view

Side view

Broken line on package



The starting point



Tear the package along the broken line



Appearance after removing the upper carton

Unpacking Instructions

9/12

6. Remove the inner packing straps

Cut off all straps inside the package, including the bottom belt hidden by the box. Do NOT remove the 2 straps on the outside of the packaging.

Attention :

- Please wear gloves to prevent hand injury.
- Please pay attention to not remove the two lower packing straps of the outer packing.
- The lower cardboard can be removed. Behind it packing straps appear at the bottom. Please remove them first to unpack the module.

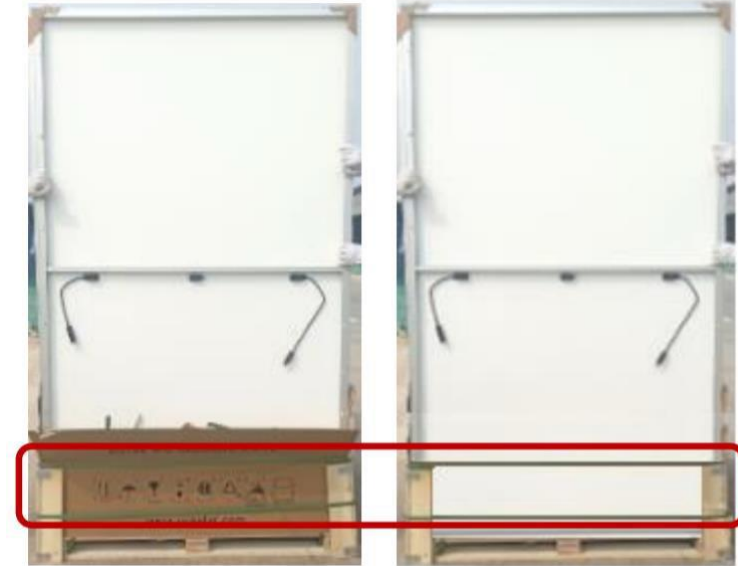

Do not remove!

Unpacking Instructions

10/12

7. Tear off the anti-tipping tape: one by one

CS7N & CS7L module packaging comes along with an ultra-high viscosity tape on both sides to prevent the modules from falling while being unpacked. Please remove the adhesive tape one by one so that only one module can be removed at a time before removing the tape from the next module.

Attention :

- Please wear gloves to prevent hand injury.
- Please tear the tape to take only one module out at a time. Do not tear the tape on the next piece of module



8. Tear off the anti-tipping tape: one by one

Two workers are required to take modules out of the box. When handling modules always use both hands.

Attention :

- Please wear gloves to prevent hand injury.
- It is recommended that two workers take out the modules from both sides of the packaging at the same time.
- The module packaging is tight, please move the first piece from left and right parallel to the short side of the module, pulling up while you move, carefully take out the first piece of module.
- Need people to support the unpacking modules during the whole process.
- Please install the modules right after unpacking. and install the modules in one time once opening the package. Do not leave a few pieces in the packing box for a long time.
- Sort out the empty packaging, separating the different materials for proper recycling.



Unpacking Instructions

12/12

Attention :

- Please take photos and contact the local sales/customer service staff at first time if you encounter with damaged package or modules, and feedback to the service mailbox, support@csisolar.com , thanks!
- If the customer does not unpack the module according to the steps specified in this manual, we shall not assume any responsibility for the personal and property damage.



Damaged package



Damaged module

Transport Service

Transport Service - Modes

Flexible and reliable service!

We are delivering our Container direct from China in Container (Incoterm CIF) or through our Warehouse in Netherlands with trucks.

Ground (1-7 days)

Standard Mode ex warehouse Rotterdam



FTL = Full Truck Load
Rates per unit



Rates per container/railway wagon



LTL = Less than Truck Load
Rates per kg or loading meters



Groupage
Rates on kg/cbm-basis

CEP (Courier/Express/Parcel)

Mode for urgent and/or small shipments (components)



Rates per kg



Rates per dedicated solution

Seafreight (4 weeks)

Standard Mode for Import from China

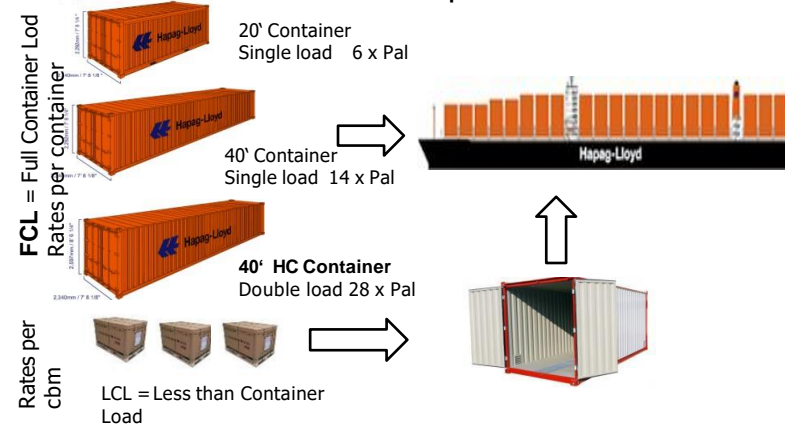

Airfreight

Mode for urgent International Transports

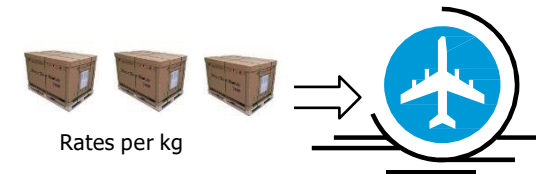

Rates per kg

Transport Service – Trucks

We are delivering in different kind of trucks from the warehouse in Netherlands to our customers

Different kind of trucks

- Standard Trucks
 - Guardrail Trucks
 - Flatbed Trucks
 - Curtain Side Trucks
-
- Our common truck used is the Standard Truck
 - The Curtain Side truck can be used if the consignee cannot provide a loading dock
 - Based on forklift capabilities 4 pallets at once can be unloaded (**not valid for (Bi)HiKu7 modules**)
 - Pallets shall be placed closely to each other and secured with required lashing (according to national traffic laws) to prevent from moving



Transport Service - Load Securing

- The forwarding agency is responsible, that his driver must secure and need to check the securing (form fitted/direct restraint only) and the weight distribution of the goods/pallets on the trailer.
- The forwarding agency must ensure that the trailer is fully equipped, in good technical condition, safe to operate and complies with the respective road traffic regulations.
- If the cargo is damaged during carriage, the carrier is liable.



Customs clearance

Customs Clearance

1/3

All products which need to be imported/exported have a clear material classification (HS code)

- The HS code is a **description and coding system** aimed at providing a **worldwide uniform classification of goods**.
- The **World Customs Organization** creates international classification (**HS codes**) for all traded products and has been administering **6-digits HS codes** schedule.
- Individual countries have extended to further digits of HS coding based on 6-digits nomenclature.
- The European Union unified it into the **TARIC code*** (Integrated Tariff of the European Communities)



* The **TARIC code** is designed to show the various rules applying to specific products when imported into the EU.

Structure of the Code number

2/3

- (1) The eleven digit code number is based on the **Harmonised System (HS)** which is administrated by the World Customs Organization (WCO) and determines the **first six digits** of the code number. The HS is a description and coding system aimed at providing a worldwide uniform classification of goods.
- (2) Building on this six digit code, the HS is extended with **two digits** by the **combined nomenclature (CN)** of the European Communities (places 7+8 of the code number). On the basis of this eight digit number, customs duties, textiles categories, bans and restrictions, or facts relating to import authorisations can be assigned during import clearance.
- (3) The **ninth and tenth digits** (known as **TARIC**=Integrated Tariff of the European Communities) encodes Community measures such as antidumping rules, duty suspensions or tariff quotas.
- (4) The **eleventh digit** of the code number is for **national use only**, and is, for example, used to encode VAT rates or national bans or restrictions.
- (5) The 11 digit code number must always be stated in an import declaration.

Customs Clearance

3/3

HS Codes applicable for modules, components and tools (EU)

Product	HS Code	Produced in
Solar panels with monocrystalline cells	8541 43	China
Solar panels with polycrystalline cells	8541 43	China
Solar panels with monocrystalline cells	8541 43	Taiwan
Solar panels with polycrystalline cells	8541 43	Taiwan
Solar panels with monocrystalline cells	8541 43	Others
Solar panels with polycrystalline cells	8541 43	Others
Connector => 1000 V	8535 90	China
Connector < 1000 V	8536 90	China
Jumper Cable	8544 42	China
Disconnect Tools	8206 00	China
Toolkit	8206 00	China
Inverter - Having a power handling capacity not exceeding 7,5 kVA	8504 40	China
Inverter - Having a power handling capacity exceeding 7,5 kVA	8504 40	China
WIFI Sticks	8517 62	China

You can contact Canadian Solar for more information!

Product Master Data

Overview – Monofacial Modules

12 years

25* years

* HiHero

PRODUCT WARRANTY ON MATERIALS AND WORKMANSHIP

25 years

30* years

* HiHero

LINEAR POWER OUTPUT WARRANTY

HiHero 
CS6R-H-AG

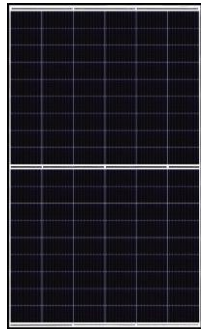

HiKuBlack & HiKu 
CS3L-MS All-Black
CS3L-P / CS3L-MS / CS3N-MS

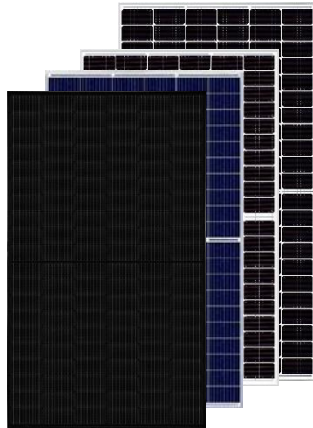

HiKu   
CS3W-P / CS3W-MS



HiKu5  
CS3Y-P / CS3Y-MS



HiKu6  
CS6W-MS

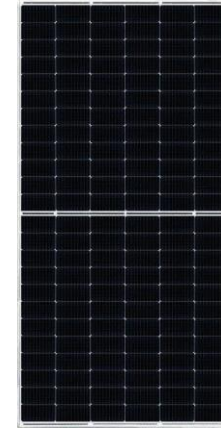

HiKu7  
CS7L-MS / CS7N-MS

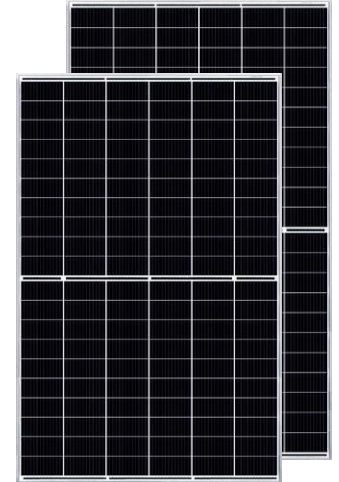

Wattage:	6R-H-AG: 405-430 W	3L-MS AB: 345-370 W 3L-P: 355-370 W 3L-MS: 360-385 W 3N-MS: 400-425 W	3W-P: 430-450 W 3W-MS: 435-460 W	3Y-P: 465-485 W 3Y-MS: 475-500 W	6W-MS: 525-550 W	7L-MS: 580-605 W 7N-MS: 640-665 W
Efficiency:	6R-H-AG: 22.0%	3L-MS AB / 3L-P: 20.0% 3L-MS: 20.8% 3N-MS: 20.9%	3W-P: 20.4% 3W-MS: 20.8%	3Y-P: 20.6% 3Y-MS: 21.2%	6W-MS: 21.5%	7L-MS: 21.4% 7N-MS: 21.4%
Cells:	182mm half-cut HJT	166mm half-cut poly/mono-PERC	166mm half-cut poly/mono-PERC	166mm half-cut poly/mono-PERC	182mm half-cut mono-PERC	210mm half-cut mono-PERC
Dimensions:	1727 x 1134 x 35 mm	3L-MS AB: 1765 x 1048 x 35 mm 3L-P / MS: 1765 x 1048 x 35 mm 3N-MS: 1940 x 1048 x 35 mm	2108 x 1048 x 35 mm	2252 x 1048 x 35 mm	2261 x 1134 x 35 mm	7L-MS: 2172 x 1303 x 35 mm 7N-MS: 2384 x 1303 x 35 mm
Weight:	23.0 kg	3L-MS AB/ 3L-P/MS: 20.5 kg 3N-MS: 22.5 kg	24.3 kg	25.7 kg	27.8 kg	7L-MS: 31.4 kg 7N-MS: 34.4 kg
Per Pallet / Container:	30 / 780 pcs low profile pallet	3L-MS AB / 3L-P/MS: 30 / 780 pcs 3N-MS: 30 / 720 pcs	30 / 660 pcs	30 / 600 pcs	30 / 600 pcs low profile pallet	31 / 527 pcs
Especially suitable for:	Residential	Residential	Residential, Commercial & Utility	Commercial & Utility	Commercial & Utility	Commercial & Utility



Overview – Bifacial Modules

12
years



PRODUCT WARRANTY
ON MATERIALS AND WORKMANSHIP

30
years

LINEAR POWER
OUTPUT
WARRANTY

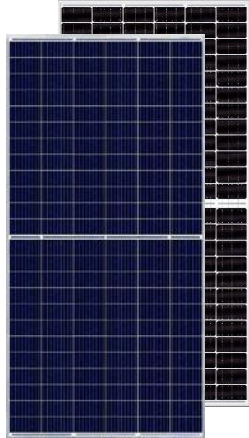
BiHiKu  
CS3W-PB-AG
CS3W-MB-AG



BiHiKu5  
CS3Y-PB-AG
CS3Y-MB-AG

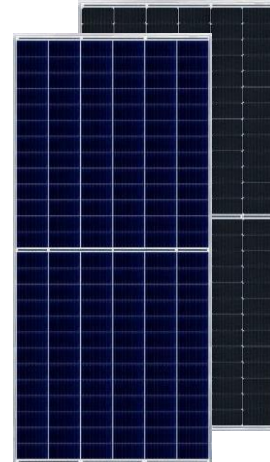

BiHiKu6  
CS6W-MB-AG

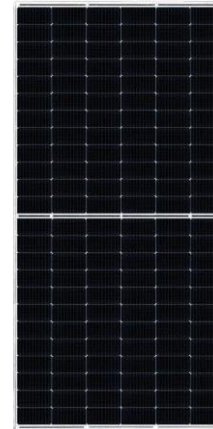

BiHiKu7  
CS7L-MB-AG



BiHiKu7  
CS7N-MB-AG

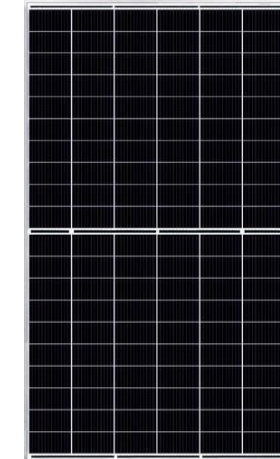

Wattage: 3W-PB: 420-440 W
3W-MB: 430-455 W

Efficiency: 3W-PB: 19.7%
3W-MB: 20.4%

Cells: 166mm half-cut
poly/mono-PERC

Dimensions: 2108 x 1048 x 35 mm

Weight: 24.2kg

**Per Pallet /
Container:** 30 / 660 pcs

**Especially
suitable for:** Commercial & Utility

3Y-PB: 460-480 W
3Y-MB: 465-490 W

3Y-PB: 20.3%
3Y-MB: 20.7%

166mm half-cut
poly/mono-PERC

2260 x 1048 x 32 mm

29.9kg

33 / 660 pcs

Commercial & Utility

6W-MB: 520-545 W

21.2%

182mm half-cut
mono-PERC

2266 x 1134 x 35 mm

32.2kg

30 / 600 pcs
low profile pallet

Commercial & Utility

7L-MB: 575-600 W

21.2%

210mm half-cut
mono- PERC

2172 x 1303 x 35 mm

34.6kg

31 / 527 pcs

Commercial & Utility

7N-MB: 635-655 W

21.1%

210mm half-cut
mono- PERC

2384 x 1303 x 35 mm

37.9kg

31 / 527 pcs

Commercial & Utility





Overview – Inverters

CSI-3-5K-S22002-E



Nominal Power: 3/3.68/5kW
Single Phase

Key Features:





-  98% Maximum efficiency up to 98%
-  1/2 MPPTs with wide range of 60 - 550 V_{DC}
-  Fuseless design
-  Real-time monitoring with Cloud platform

CSI-25-40K-T400-GL02-E



Nominal Power: 25/30/33/36/40kW
Three Phase

Key Features:





-  98.8% Maximum efficiency up to 98.8%
-  3/4 MPPTs with wide range of 200 - 1000 V_{DC}
-  Fuseless design
-  Smart String monitoring & IV curve diagnosis

CSI-50-60K-T400-GL03-E



Nominal Power: 50/60kW
Three Phase

Key Features:





-  98.7% Maximum efficiency up to 98.7%
-  5/6 MPPTs with wide range of 180 - 1000 V_{DC}
-  Fuseless design
-  Smart String monitoring & IV curve diagnosis

CSI-100-110K-T400-GL02-E



Nominal Power: 100/110kW
Three Phase

Key Features:

-  98.7% Maximum efficiency up to 98.7%
-  10 MPPTs with wide range of 180 - 1000 V_{DC}
-  Fuseless design
-  Smart String monitoring & IV curve diagnosis

For South Africa
CSI-100-110K-T400-GL02-ZA
with SPD Type I protection

Product Measurements – Modules

1/8

Single Module

Type	Family	Dimensions (mm)			Weight	Frame
		L	W	H	KG	
CS3L	HiKu	1765	1048	40	20,6	F9
CS3L	HiKu	1765	1048	40	21,1	F9H
CS3L	HiKu	1765	1048	35	20,5	F30
CS3L	HiKu	1765	1048	35	21	F30E
CS3L	HiKu	1765	1048	35	16,2	F31
CS3N	HiKu	1940	1048	35	22,5	F30
CS3W	HiKu	2108	1048	40	24,9	F9
CS3W	HiKu	2108	1048	35	24,3	F30
CS3W	HiKu	2108	1048	35	24,8	F30E
CS3W-M/PB-AG	BiHiKu	2132	1048	30	28,2	F26/27
CS3W-M/PB-AG	BiHiKu	2132	1048	30	28,4	F26
CS3Y	HiKu5	2252	1048	35	25,7	F50
CS3Y-M/PB-AG	BiHiKu5	2260	1048	32	29,9	F41
CS3S	Ku5	2168	996	35	23,7	F50
CS6PH	Classic	1638	982	40	18	F1
CS6PH	Classic	1638	982	35	18	F16
CS6XH	Classic	1954	982	40	21,6	F1
CS6XH	Classic	1954	982	35	21,6	F16
CS6X-P-PLUS	Classic PLUS	1954	982	40	21,5	F1
CS6X-P-PLUS	Classic PLUS	1954	982	35	21	F30
CS6P-P-PLUS	Classic PLUS	1638	982	40	18	F1
CS6P-P-PLUS	Classic PLUS	1638	982	35	18	F16
CS6W	HiKu6	2261	1134	35	27,8	F50A
CS6W-MB-AG	BiHiKu6	2266	1134	35	32,2	F42
CS7L	HiKu7	2172	1303	35	31,4	F52
CS7L	HiKu7	2172	1303	35	31	F53A
CS7L-MS-R	HiKu7	2172	1303	35	31	F53A
CS7N	HiKu7	2384	1303	35	34,4	F52/F53A
CS7N-MB-AG	BiHiKu7	2384	1303	35	37,9	F43/F43M
CS7L-MB-AG	BiHiKu7	2172	1303	35	34,6	F43/F43M
CS6R	HiKu6	1722	1134	30	21,3	F55
CS6R-H-AG	HiHero	1727	1134	35	23	F42

Product Measurements – Modules

2/8

Carton

Type	Family	Dimensions Empty carton			Modules / Carton	Frame
		L	W	H	Pieces	
CS3L	HiKu	1780	1095	1050	27	F9
CS3L	HiKu	1780	1095	1050	27	F9H
CS3L	HiKu	1780	1066	1050	30	F30
CS3L	HiKu	1780	1066	1050	30	F30E
CS3L	HiKu	1780	1066	1050	30	F31
CS3N	HiKu	1955	1066	1050	30	F30
CS3W	HiKu	2123	1095	1050	27	F9
CS3W	HiKu	2123	1066	1050	30	F30
CS3W	HiKu	2123	1066	1050	30	F30E
CS3W-M/PB-AG	BiHiKu	2147	1075	1050	35	F26/27
CS3W-M/PB-AG	BiHiKu	2147	1075	1050	33	F26
CS3Y	HiKu5	2265	1066	1050	30	F50
CS3Y-M/PB-AG	BiHiKu5	2275	1066	1050	33	F41
CS3S	Ku5	2183	1066	1000	30	F50
CS6PH	Classic	1655	1095	985	27	F1
CS6PH	Classic	1655	1066	985	30	F16
CS6XH	Classic	1970	1095	985	27	F1
CS6XH	Classic	1970	1066	985	30	F16
CS6X-P-PLUS	Classic PLUS	1970	1095	985	27	F1
CS6X-P-PLUS	Classic PLUS	1970	1066	985	30	F30
CS6P-P-PLUS	Classic PLUS	1655	1095	985	27	F1
CS6P-P-PLUS	Classic PLUS	1655	1066	985	30	F16
CS6W	HiKu6	2276	1066	1140	30	F50A
CS6W-MB-AG	BiHiKu6	2276	1066	1140	30	F42
CS7L	HiKu7	1305	1090	1893	31	F52
CS7L	HiKu7	1305	1090	1893	31	F53A
CS7L-MS-R	HiKu7	1305	1090	1893	31	F53A
CS7N	HiKu7	1305	1090	2105	31	F52/F53A
CS7N-MB-AG	BiHiKu7	1305	1090	2105	31	F43/F43M
CS7L-MB-AG	BiHiKu7	1305	1090	1893	31	F43/F43M
CS6R	HiKu6	1737	1060	1140	35	F55
CS6R-H-AG	HiHero	1742	1066	1140	30	F42

Product Measurements – Modules

3/8

Pallet

Type	Family	Modules / Pallet	Dimensions Empty			Dimensions Loaded			Gross Weight	Frame
		Pieces	L	W	H	L	W	H		
CS3L	HiKu	27	1805	1130	140	1805	1130	1205	600	F9
CS3L	HiKu	27	1805	1130	140	1805	1130	1205	614	F9H
CS3L	HiKu	30	1805	1100	140	1805	1100	1205	658	F30
CS3L	HiKu	30	1805	1100	140	1805	1100	1205	673	F30E
CS3L	HiKu	30	1805	1100	140	1805	1100	1205	530	F31
CS3N	HiKu	30	1985	1100	140	1985	1100	1205	723	F30
CS3W	HiKu	27	2155	1130	140	2155	1130	1205	725	F9
CS3W	HiKu	30	2155	1100	140	2155	1100	1205	782	F30
CS3W	HiKu	30	2155	1100	140	2155	1100	1205	797	F30E
CS3W-M/PB-AG	BiHiKu	35	2200	1140	144	2200	1140	1205	1044	F26/27
CS3W-M/PB-AG	BiHiKu	33	2200	1140	144	2200	1140	1205	995	F26
CS3Y	HiKu5	30	2295	1100	140	2295	1100	1205	822	F50
CS3Y-M/PB-AG	BiHiKu5	33	2335	1130	144	2335	1130	1205	1045	F41
CS3S	Ku5	30	2215	1100	140	2215	1100	1150	762	F50
CS6PH	Classic	27	1685	1130	140	1685	1130	1140	525	F1
CS6PH	Classic	30	1685	1100	140	1685	1100	1140	580	F16
CS6XH	Classic	27	1995	1130	140	1995	1130	1140	630	F1
CS6XH	Classic	30	1995	1100	140	1995	1100	1140	695	F16
CS6X-P-PLUS	Classic PLUS	27	1995	1130	140	1995	1130	1140	627	F1
CS6X-P-PLUS	Classic PLUS	30	1995	1100	140	1995	1100	1140	677	F30
CS6P-P-PLUS	Classic PLUS	27	1685	1130	140	1685	1130	1140	525	F1
CS6P-P-PLUS	Classic PLUS	30	1685	1100	140	1685	1100	1140	580	F16
CS6W	HiKu6	30	2305	1100	105	2305	1100	1250	887	F50A
CS6W-MB-AG	BiHiKu6	30	2335	1130	105	2335	1130	1250	1025	F42
CS7L	HiKu7	31	1305	1100	105	1340	1135	2282	1021	F52
CS7L	HiKu7	31	1305	1100	105	1340	1135	2282	1008	F53A
CS7L-MS-R	HiKu7	31	1305	1100	105	1340	1135	2282	1008	F53A
CS7N	HiKu7	31	1305	1100	105	1340	1135	2500	1114	F52/F53A
CS7N-MB-AG	BiHiKu7	31	1305	1100	105	1340	1135	2500	1223	F43/F43M
CS7L-MB-AG	BiHiKu7	31	1305	1100	105	1340	1135	2282	1121	F43/F43M
CS6R	HiKu6	35	1795	1130	110	1795	1130	1255	795	F55
CS6R-H-AG	HiHero	30	1800	1130	105	1800	1130	1250	735	F42

Product Measurements – Modules

4/8

Pallets per Container

Type	Family	Pallets / 20 ft Container	Pallets / 40 ft Container	Pallets / 40 HQ Container	Frame
		pallets	pallets	pallets	
CS3L	HiKu	6	13	26	F9
CS3L	HiKu	6	13	26	F9H
CS3L	HiKu	6	13	26	F30
CS3L	HiKu	6	13	26	F30E
CS3L	HiKu	6	13	26	F31
CS3N	HiKu	5	12	24	F30
CS3W	HiKu	5	11	22	F9
CS3W	HiKu	5	11	22	F30
CS3W	HiKu	5	11	22	F30E
CS3W-M/PB-AG	BiHiKu	5	10	20	F26/27
CS3W-M/PB-AG	BiHiKu	5	10	20	F26
CS3Y	HiKu5	5	10	20	F50
CS3Y-M/PB-AG	BiHiKu5	5	10	20	F41
CS3S	Ku5	5	10	20	F50
CS6PH	Classic	6	14	28	F1
CS6PH	Classic	6	14	28	F16
CS6XH	Classic	5	12	24	F1
CS6XH	Classic	5	12	24	F16
CS6X-P-PLUS	Classic PLUS	5	12	24	F1
CS6X-P-PLUS	Classic PLUS	5	12	24	F30
CS6P-P-PLUS	Classic PLUS	6	14	28	F1
CS6P-P-PLUS	Classic PLUS	6	14	28	F16
CS6W	HiKu6	5	10	20	F50A
CS6W-MB-AG	BiHiKu6	5	10	20	F42
CS7L	HiKu7	NA	NA	17	F52
CS7L	HiKu7	NA	NA	17	F53A
CS7L-MS-R	HiKu7	NA	NA	17	F53A
CS7N	HiKu7	NA	NA	17	F52/F53A
CS7N-MB-AG	BiHiKu7	NA	NA	17	F43/F43M
CS7L-MB-AG	BiHiKu7	NA	NA	17	F43/F43M
CS6R	HiKu6	6	13	26	F55
CS6R-H-AG	HiHero	6	13	26	F42

Product Measurements – Modules

5/8

Pieces (modules) per Container

Type	Family	20 ft Container	40 ft Container	40 HQ Container	Frame
		modules	modules	modules	
CS3L	HiKu	162	351	702	F9
CS3L	HiKu	162	351	702	F9H
CS3L	HiKu	180	390	780	F30
CS3L	HiKu	180	390	780	F30E
CS3L	HiKu	180	390	780	F31
CS3N	HiKu	150	360	720	F30
CS3W	HiKu	135	297	594	F9
CS3W	HiKu	150	330	660	F30
CS3W	HiKu	150	330	660	F30E
CS3W-M/PB-AG	BiHiKu	175	350	700	F26/F27
CS3W-M/PB-AG	BiHiKu	165	330	660	F26
CS3Y	HiKu5	150	300	600	F50
CS3Y-M/PB-AG	BiHiKu5	165	330	660	F41
CS3S	Ku5	150	300	600	F50
CS6PH	Classic	162	378	756	F1
CS6PH	Classic	180	420	840	F16
CS6XH	Classic	135	324	648	F1
CS6XH	Classic	150	360	720	F16
CS6X-P-PLUS	Classic PLUS	135	324	648	F1
CS6X-P-PLUS	Classic PLUS	150	360	720	F30
CS6P-P-PLUS	Classic PLUS	162	378	756	F1
CS6P-P-PLUS	Classic PLUS	180	420	840	F16
CS6W	HiKu6	150	300	600	F50A
CS6W-MB-AG	BiHiKu6	150	300	600	F42
CS7L	HiKu7	NA	NA	527	F52
CS7L	HiKu7	NA	NA	527	F53A
CS7L-MS-R	HiKu7	NA	NA	527	F53A
CS7N	HiKu7	NA	NA	527	F52/F53A
CS7N-MB-AG	BiHiKu7	NA	NA	527	F43/F43M
CS7L-MB-AG	BiHiKu7	NA	NA	527	F43/F43M
CS6R	HiKu6	210	455	910	F55
CS6R-H-AG	HiHero	180	390	780	F42

Product Measurements – Modules

6/8

20ft Container Weight & Volume

Type	Family	Gross Weight (kg)	Net Weight (kg)	Volume (CMB)	Frame
CS3L	HiKu	3.600	3.337	14,75	F9
CS3L	HiKu	3.684	3.418	14,75	F9H
CS3L	HiKu	3.948	3.690	14,36	F30
CS3L	HiKu	4.038	3.780	14,36	F30E
CS3L	HiKu	3.180	2.916	14,36	F31
CS3N	HiKu	3.615	3.375	13,16	F30
CS3W	HiKu	3.625	3.362	14,67	F9
CS3W	HiKu	3.910	3.645	14,28	F30
CS3W	HiKu	3.985	3.720	14,28	F30E
CS3W-M/PB-AG	BiHiKu	5.220	4.935	15,11	F26/27
CS3W-M/PB-AG	BiHiKu	4.975	4.686	15,11	F26
CS3Y	HiKu5	4.110	3.855	15,21	F50
CS3Y-M/PB-AG	BiHiKu5	5.225	4.934	15,90	F41
CS3S	Ku5	3.810	3.555	14,01	F50
CS6PH	Classic	3.150	2.916	13,02	F1
CS6PH	Classic	3.480	3.240	12,68	F16
CS6XH	Classic	3.150	2.916	12,85	F1
CS6XH	Classic	3.475	3.240	12,51	F16
CS6X-P-PLUS	Classic PLUS	3.135	2.903	12,85	F1
CS6X-P-PLUS	Classic PLUS	3.385	3.150	12,51	F30
CS6P-P-PLUS	Classic PLUS	3.150	2.916	13,02	F1
CS6P-P-PLUS	Classic PLUS	3.480	3.240	12,68	F16
CS6W	HiKu6	4.435	4.170	15,85	F50A
CS6W-MB-AG	BiHiKu6	5.125	4.830	16,49	F42
CS7L	HiKu7				F52
CS7L	HiKu7				F53A
CS7L-MS-R	HiKu7				F53A
CS7N	HiKu7				F52/F53A
CS7N-MB-AG	BiHiKu7				F43/F43M
CS7L-MB-AG	BiHiKu7				F43/F43M
CS6R	HiKu6	4.770	4.473	15,27	F55
CS6R-H-AG	HiHero	4.410	4.140	15,26	F42

Product Measurements – Modules

7/8

40ft Container Weight & Volume

Type	Family	Gross Weight (kg)	Net Weight	Volume (CMB)	Frame
CS3L	HiKu	7.800	7.231	31,95	F9
CS3L	HiKu	7.982	7.406	31,95	F9H
CS3L	HiKu	8.554	7.995	31,10	F30
CS3L	HiKu	8.749	8.190	31,10	F30E
CS3L	HiKu	6.890	6.318	31,10	F31
CS3N	HiKu	8.676	8.100	31,57	F30
CS3W	HiKu	7.975	7.395	32,28	F9
CS3W	HiKu	8.602	8.019	31,42	F30
CS3W	HiKu	8.767	8.184	31,42	F30E
CS3W-M/PB-AG	BiHiKu	10.440	9.870	30,22	F26\27
CS3W-M/PB-AG	BiHiKu	9.950	9.372	30,22	F26
CS3Y	HiKu5	8.220	7.710	30,42	F50
CS3Y-M/PB-AG	BiHiKu5	10.450	9.867	31,79	F41
CS3S	Ku5	7.620	7.110	28,02	F50
CS6PH	Classic	7.350	6.804	30,39	F1
CS6PH	Classic	8.120	7.560	29,58	F16
CS6XH	Classic	7.560	6.998	30,84	F1
CS6XH	Classic	8.340	7.776	30,02	F16
CS6X-P-PLUS	Classic PLUS	7.524	6.966	30,84	F1
CS6X-P-PLUS	Classic PLUS	8.124	7.560	30,02	F30
CS6P-P-PLUS	Classic PLUS	7.350	6.804	30,39	F1
CS6P-P-PLUS	Classic PLUS	8.120	7.560	29,58	F16
CS6W	HiKu6	8.870	8.340	31,69	F50A
CS6W-MB-AG	BiHiKu6	10.250	9.660	32,98	F42
CS7L	HiKu7				F52
CS7L	HiKu7				F53A
CS7L-MS-R	HiKu7				F53A
CS7N	HiKu7				F52/F53A
CS7N-MB-AG	BiHiKu7				F43/F43M
CS7L-MB-AG	BiHiKu7				F43/F43M
CS6R	HiKu6	10.335	9.692	33,09	F55
CS6R-H-AG	HiHero	9.555	8.970	33,05	F42

Product Measurements – Modules

8/8

40ft HQ container Weight & Volume

Type	Family	Gross Weight (kg)	Net Weight	Volume (CMB)	Frame	Status
CS3L	HiKu	15.600	14.461	63,90	F9	phased out
CS3L	HiKu	15.964	14.812	63,90	F9H	phased out
CS3L	HiKu				F30	
CS3L	HiKu	17.108	15.990	62,21	F30	
CS3L	HiKu	17.498	16.380	62,21	F30E	
CS3N	HiKu	17.352	16.200	63,15	F30	
CS3W	HiKu	15.950	14.791	64,56	F9	phased out
CS3W	HiKu	17.204	16.038	62,84	F30	
CS3W	HiKu	17.534	16.368	62,84	F30E	
CS3W-M/PB-AG	BiHiKu	20.880	19.740	60,44	F26\27	
CS3W-M/PB-AG	BiHiKu	19.900	18.744	60,44	F26	
CS3Y	HiKu5	16.440	15.420	60,84	F50	phased out
CS3Y-M/PB-AG	BiHiKu5	20.900	19.734	63,59	F41	phased out
CS3S	Ku5	15.240	14.220	56,04	F50	phased out
CS6PH	Classic	14.700	13.608	60,78	F1	
CS6PH	Classic	16.240	15.120	59,16	F16	
CS6XH	Classic	15.120	13.997	61,68	F1	
CS6XH	Classic	16.680	15.552	60,04	F16	
CS6X-P-PLUS	Classic PLUS	15.048	13.932	61,68	F1	
CS6X-P-PLUS	Classic PLUS	16.248	15.120	60,04	F30	
CS6P-P-PLUS	Classic PLUS	14.700	13.608	60,78	F1	
CS6P-P-PLUS	Classic PLUS	16.240	15.120	59,16	F16	
CS6W	HiKu6	17.740	16.680	63,39	F50A	
CS6W-MB-AG	BiHiKu6	20.500	19.320	65,96	F42	
CS7L	HiKu7	17.357	16.548	59,00	F52	
CS7L	HiKu7	17.136	16.337	59,00	F53A	
CS7L-MS-R	HiKu7	17.136	16.337	59,00	F53A	
CS7N	HiKu7	18.938	18.129	64,64	F52/F53A	
CS7N-MB-AG	BiHiKu7	20.791	19.973	64,64	F43/F43M	
CS7L-MB-AG	BiHiKu7	19.057	18.234	59,00	F43/F43M	
CS6R	HiKu6 Mini		19.937	65,47	F55	preliminary
CS6R-H-AG	HiHero	19.110	17.940	66,11	F42	preliminary

Product measurements - Inverter













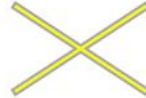

Package Dimension & Weight

Inverters Type	Package Dimension (mm) (L x W x D)	Weight (kg)	Gross Weights (kg)
CSI-3K-S22002-E	380 x 480 x 240	8.2	10
CSI-3.68K-SS22002-E	450 x 565 x 240	13.5	16
CSI-5K-SS22002-E	450 x 565 x 240	13.5	16
CSI-25K-T400GL02-E	730 x 630 x 352	39.3	45.5
CSI-30K-T400GL02-E	730 x 630 x 352	39.3	45.5
CSI-33K-T400GL02-E	730 x 630 x 352	39.3	45.5
CSI-36K-T400GL02-E	730 x 630 x 352	45.4	52.1
CSI-40K-T400GL02-E	730 x 630 x 352	45.4	52.1
CSI-50K-T400GL03-E	861 x 761 x 458	54.5	64.5
CSI-60K-T400GL03-E	861 x 761 x 458	54.5	64.5
CSI-100K-T400GL02-E	1180 x 700 x 560	100.5	111.2
CSI-100K-T400GL02-ZA	1180 x 700 x 560	100.5	111.2
CSI-110K-T400GL02-E	1180 x 700 x 560	100.5	111.2
CSI-110K-T400GL02-ZA	1180 x 700 x 560	100.5	111.2
CSI-20KTL-GI-FL	815 x 645 x 460	63.4	68.8
CSI-40-50KTL-GI-FL	800 x 760 x 470	76.7	82.1

Product measurements – Connectors & Co.

Package Dimension & Weight

Logistics Information Tlian Products

	T4 Connectors	Disconnect Tools	Toolkit
			
	1 pair = 1 piece (+) and 1 piece (-)	1 piece = 1 tool	1 piece = 1 toolkit
	25 pairs	10 pieces	10 pieces
		270 x 150 x 30 mm 0.155 kg	270 x 150 x 30 mm 0.17 kg
Bags			
	(!) Please note the MoQ	(!) Please note the MoQ	(!) Please note the MoQ
	100 pairs	80 pieces	100 pieces
	4 bags (+) & 4 bags (-)	8 x Bags	10 x Bags
	450 x 117 x 215 mm 4.2 kg	450 x 117 x 215 mm 1.53 kg	450 x 117 x 215 mm 1.95 kg
Small Box			
	500 pairs	400 pieces	500 pieces
	5 x Small Boxes	5 x Small Boxes	5 x Small Boxes
	610 x 470 x 235 mm 22.84 kg	610 x 470 x 235 mm 9.3 kg	600 x 420 x 220 mm 10.95 kg
Big Box			
	8,000 pairs	6,400 pieces	8,000 pieces
	16 x Big Boxes	16 x Big Boxes	16 x Big Boxes
	1,260 x 980 x 1,125 mm 389 kg	1,260 x 980 x 1,125 mm 172 kg	1,260 x 980 x 1,070 mm 197.7 kg
Pallet			
MoQ	100 pairs and multiples	10 pieces and multiples	1 piece and multiples

THANK YOU