

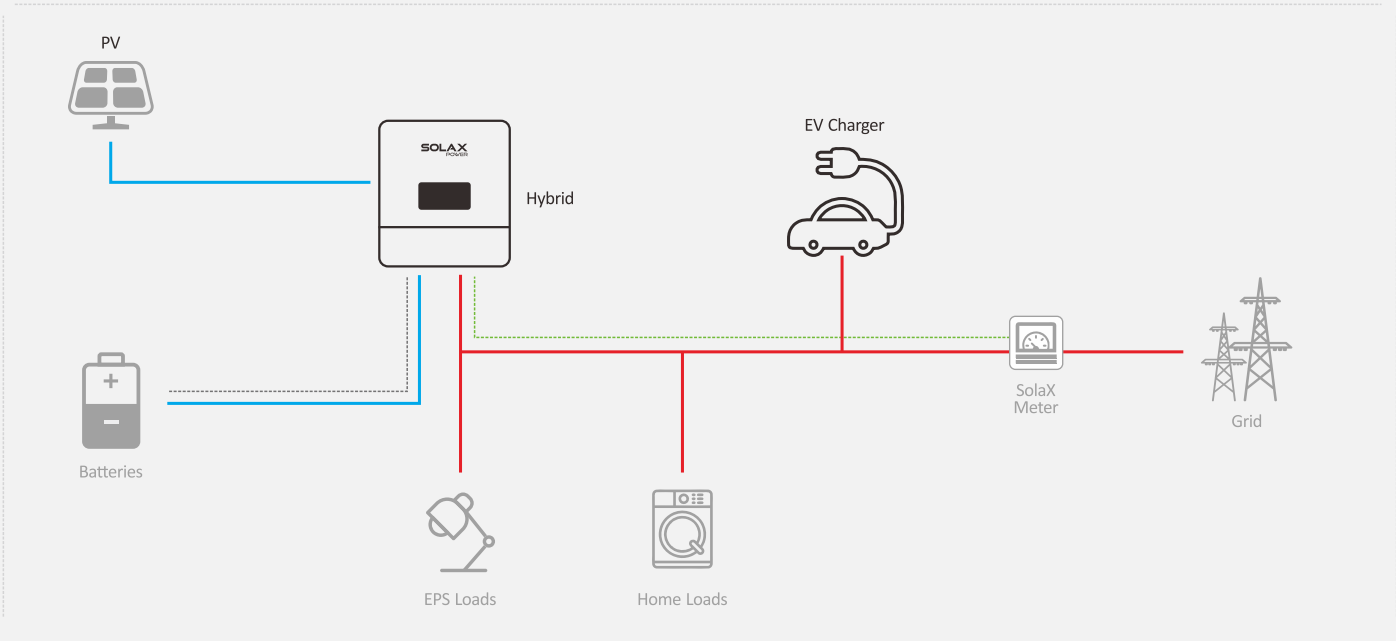

SMART HOME EV CHARGER





Innovativeness

Minimal size,streamline design
Home use with intelligent App control

Secure and Safe

6mA DC residual current protection
Anti-welding protection

Intelligent Control

OCPP communication protocol with CMS
Smart charger or scheduled charger by App

Flexible Option

Type 1 or Type 2 charging cable
App operation or RFID authentication or
plug and play
Wall-mount or floor-stand installation

X1-AE-7kW

X3-AE-11kW

Input

Power Supply	1P+N+PE	3P+N+PE
Rated Voltage [V]	230	400
Rated Current [A]	32	16
Frequency [Hz]	50/60	50/60

Output

Output Voltage [V]	230	400
Maximum Current [A]	32	16
Rated Power [W]	7000	11000

User Interface

Charger Connector	Type 2 cable	Type 2 cable
Cable Length [m]	4	4
Enclosure	Plastic PC940	Plastic PC940
LED Indicator	Green/Yellow/Red	Green/Yellow/Red
RFID Reader	Mifare ISO/IEC 14443 A	Mifare ISO/IEC 14443 A
Start Mode	Plug&Play/RFID card/App	Plug&Play/RFID card/App
Emergency Stop	No	No

Communication

Wi-Fi	Yes	Yes
OCPP	OCPP 1.6 JSON	OCPP 1.6 JSON

Environment

Installation	Wall-mount/Post-mount	Wall-mount/Post-mount
Work Temperature [°C]	- 30~ + 50	- 30~ + 50
Work Humidity [%]	5~95	5~95
Work Altitude [m]	<2000	<2000

Safety

Energy Meter	No	No
RCD	6mA DC	6mA DC
Ingress Protection	IP65	IP65
Impact Protection	IK10	IK10

Electrical Protection	Over current protection,Residual current protection,Ground protection,Surge protection, Over/Under voltage protection,Over/Under frequency protection,Over/Under temperature protection	
Certification	CE	CE
Certification Standard	EN/IEC 61851-1:2017,EN/ IEC 61851-21-2:2018	EN/IEC 61851-1:2017,EN/ IEC 61851-21-2:2018
Warranty [years]	2	2

Package

Product Dimension(H*W*D) [mm]	325*181*87	325*181*87
Package Dimension(L*W*H) [mm]	434*324*210	434*324*210
Net Weight [kg]	3,2	3,2
Gross Weight [kg]	4,0	4,0
External Package	Carton	Carton