

# RW-M6.1

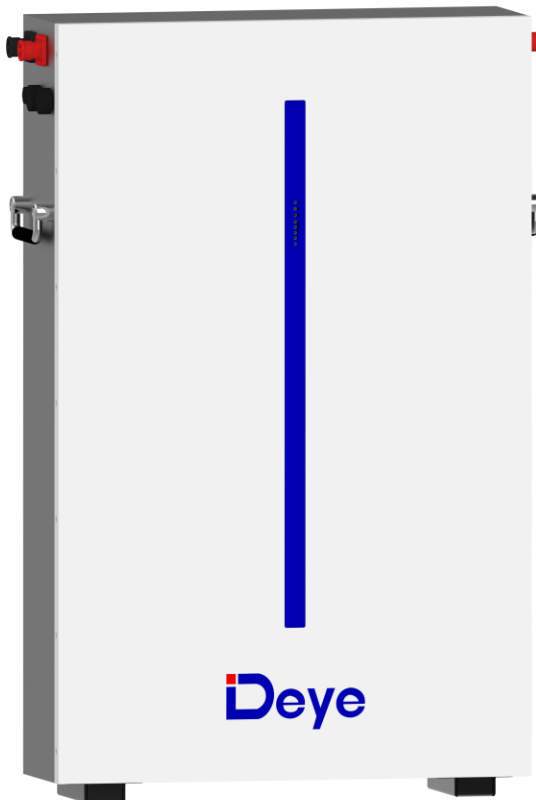

- ◆ **Safer**

Cobalt Free Lithium Iron Phosphate (LFP) Battery, safety and long lifespan, high efficiency and high-power density. Intelligent BMS, providing complete protection.

- ◆ **Reliable**

Support high discharge power. IP65, natural cooling, wide temperature range: -20°C to 55°C.

- ◆ **Flexible**

Modular design, easy to expand, Max. 32 units in parallel, Max. capacity of 196kWh. Suited to residential and commercial applications for increasing the self-consumption ratio.

- ◆ **Convenient**

Battery module auto networking, Automatic IP addressing, easy maintenance, remotely monitoring and upgrade, support USB drive upgrade the firmware.

- ◆ **Eco-Friendly**

Use environmental protection materials, the whole module non-toxic, pollution-free.

- ◆ **Wall-Mounted**

Flat design, wall-mounted, saving installation space.

Model		RW-M6.1
Main Parameter		
Battery Chemistry		LiFePO4
Capacity (Ah)		120
Scalability		Max.32 pcs in Parallel(196kWh)
Nominal Voltage (V)		51.2
Operating Voltage(V)		43.2~57.6
Energy (kWh)		6.14
Usable Energy (kWh) <sup>[1]</sup>		5.53
Charge/Discharge Current (A)	Recommend <sup>[2]</sup>	60
	Max. <sup>[2]</sup>	100
	Peak(2mins,25°C)	150
Other Parameter		
Recommend Depth of Discharge		90%
Dimension (W/H/D, mm)		475*720*145(Without Base, depth of 161mm with Hanging Board)
Weight Approximate(kg)		60
Master LED Indicator		5LED(SOC:20%~SOC100%),3LED (working, alarming, protecting)
IP Rating of Enclosure		IP65
Operating Temperature		Charge:0~55°C / Discharge:-20°C~55°C
Storage Temperature		0°C~35°C
Humidity		5%~95%
Altitude		≤2000m
Cycle Life		≥6000(25°C±2°C,0.5C/0.5C,70%EOL)
Installation		Wall-Mounted, Floor-Mounted
Communication Port		CAN2.0, RS485
Warranty Period <sup>[3]</sup>		10 years
Energy Throughput <sup>[3]</sup>		20MWh@70%EOL
Certification		UN38.3, IEC62619, CE, CEI 0-21

[1] DC Usable Energy, test conditions: 90% DOD, 0.5C charge & discharge at 25°C. System usable energy may vary due to system configuration parameters.

[2] The current is affected by temperature and SOC.

[3] The warranty is due whichever reached first of warranty period or life cycle power.

### Introduction

This series lithium iron phosphate battery is one of new energy storage products developed and produced by Deye , it can be used to support reliable power for various types of equipment and systems.

This series is especially suitable for application scene of high power, limited installation space, restricted load-bearing and long cycle life.

This series has built-in BMS battery management system, which can manage and monitor cells information including voltage, current and temperature. What's more, BMS can balance cells charging and discharging to extend cycle life. Multiple batteries can connect in parallel to expand capacity and power in parallel for larger capacity and longer power supporting duration requirements.

Model	Accessories Parts Description	Remark
RW-M6.1-Hboard	Battery Hanging Board (Included)	Used for battery fixing on the wall
RW-M6.1-Base	Battery Support Base (Included)	The Support base for battery floor-mounted
WT-CCable	Communication Cable (Included)	Battery communication cable connect with hybrid inverter
RW-M6.1-PCable	DC Power Cable (Included)	Battery power cable connect with hybrid inverter
RW-M6.1-BCable	Battery Parallel Cable (Optional)	Battery power and communication parallel connection cable



**Model: RW-M6.1-Hboard**

**Details:** 3kg(Appr.)



**Model: WT-CCable**

**Details:** 3m RJ45 communication cable, one end has a waterproof terminal



**Model: RW-M6.1-PCable**

**Details:** Pair of 4AWG DC power cable connect with hybrid inverter, one end has a waterproof terminal. The cable length can be customized based on customer requirements, default length is 2000mm.



**Model: RW-M6.1-BCable**

**Details:** Pair of 4AWG Battery power cable and RJ45 communication cable for battery parallel. The cable length can be customized based on customer requirements, default length is 600mm.

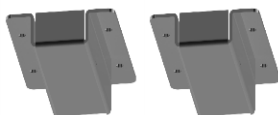

**Model: RW-M6.1-Base**

**Details:** Pair of battery support base. The Support Base for Battery Floor-mounted, height is 20mm.